



MEETING AGENDA

July 1, 2019

6:00 PM

High School Library

- 1 | Review / Approve June 25 Meeting Summary
- 2 | Review / Revised Responses to Narrowed Set of Options
- 3 | Review Updated Preliminary Budgets
- 4 | Small Group Discussion
- 5 | Discussion / Determination on 2a / 6a / 7b - can we narrow to one?
- 6 | Begin Potential Phasing Discussions
- 7 | Adjournment



REVIEW / APPROVE JUNE 25 MEETING SUMMARY

TAB 4



Preliminary Summary
To be finalized at 7/1 meeting

MEETING SUMMARY

June 25, 2019

High School Library

Learning Today, Leading Tomorrow

OVERVIEW

The meeting started off with Chet Bembenek, technology director for the Columbus School District, updating the committee on the technology in the district. Chet became the technology director for the district back in 2010. Here is a list of some of the key improvements that have been achieved since:

- Replaced old phone system with Voip System
- Laptops for teachers with docking stations - 8th year
- One device per student (1:1) - 5th year
- Raptor Visitor System
- Replacing Smartboard & Projectors with Touch TVs

Before small group discussions, Mitch Kidd from CD Smith presented preliminary budgets for the options. Each option had a total price range that was broken down into cost per school. CD Smith also presented a preliminary budget for the infrastructure needs identified in tours of the school buildings.

In small group discussions, the committee members reviewed site plans, floor plans, and budgets for the each of the options. At the end of the meeting the committee agreed to move forward with two of the options. Bray Architects and CD Smith are going to further study these options for the next meeting.

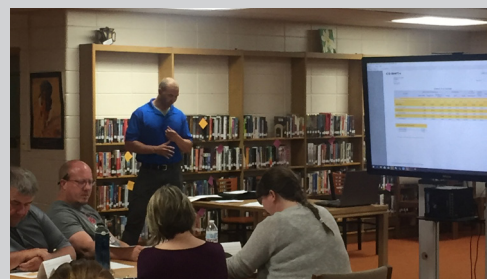
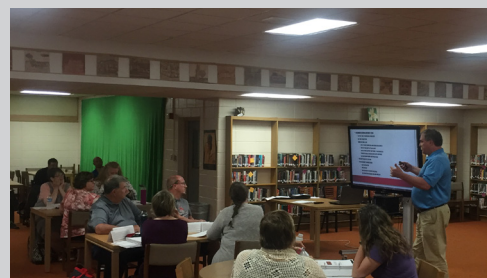

NEXT MEETING >>>

Monday, July 1 | 6:00-8:30 PM

High School - Library

- Review | Responses to Options
- Review | Preliminary Budgets
- Presentation | Athletic / Recreation / Co-Curricular Update
- Small Group Discussion | Finalize Options

FOR MORE INFORMATION:

Contact Janel DeZarn-Vert jdezarn@columbus.k12.wi.us

Visit www.columbus.k12.wi.us



REVIEW PRELIMINARY BUDGETS

TAB 9

DRAFT

	Option	Grade / Use	Additions	New Building	Demo	No Work	Notes	Value
1	Option 2A							\$70.9 Million - \$73.9 Million
2	Existing Community Partner Sites	4k				x	No Work	
3	Existing Elementary School & Discover Charter School	4k - 2nd	x				Additions and Renovations	\$10 Million - \$10.5 Million
4	Existing Intermediate/Middle School	3rd - 5th				x	Facility Maintenance	Facility Maintenance
5	Existing High School	6th - 8th	x				Additions and Renovations	\$6.2 Million - \$6.7 Million
6	New High School	9th - 12th		x			New High School	\$38 Million - \$39 Million
7	New High School - Phase 2	9th - 12th		x			New High School - Phase 2	\$6.2 Million - \$6.7 Million
8	New High School - Auditorium	9th - 12th		x			New High School - Auditorium	\$10.5 Million - \$11 Million
9								
10	Option 4							\$41.3 Million - \$43.3 Million
11	Existing Community Partner Sites	4k				x	No Work	
12	Existing Elementary School & Discover Charter School	4k - 3rd	x				Addition and Renovation	\$10 Million - \$10.5 Million
13	Existing Intermediate/Middle School	4th - 8th	x		x		Addition, Renovation, and Demo	\$8.5 Million - \$9 Million
14	Existing High School	9th - 12th	x		x		Addition, Renovation, and Demo	\$12.3 Million - \$12.8 Million
15	New High School - Auditorium	9th - 12th		x			New High School - Auditorium	\$10.5 Million - \$11 Million
16								
17	Option 6A							\$78.2 Million - \$81.2 Million
18	Existing Community Partner Sites	4k				x	No Work	
19	Existing Elementary School & Discover Charter School	4k - 4th	x				Addition and Renovation	\$12.5 Million - \$13 Million
20	Existing Intermediate/Middle School	Demo or Sell			x		Assumes Demo of Existing Building	\$2 Million
21	Existing High School	5th - 8th	x				Addition and Renovation	\$9 Million - \$9.5 Million
22	New High School	9th - 12th		x			New High School	\$38 Million - \$39 Million
23	New High School - Phase 2	9th - 12th		x			New High School - Phase 2	\$6.2 Million - \$6.7 Million
24	New High School - Auditorium	9th - 12th		x			New High School - Auditorium	\$10.5 Million - \$11 Million
25								
26	Option 7B							\$79.6 Million - \$83.1Million
27	Existing Community Partner Sites	4k				x	No Work	
28	Existing Elementary School - Potential Gym 6,000 sqft	4k - 5th	x				Addition - Gym	\$1.5 Million - \$2 Million
29	Existing Elementary School & Discover Charter School	4k - 5th	x				Addition and Renovation	\$15.2 Million - \$15.7 Million
30	Existing Intermediate/Middle School	Demo or Sell			x		Assumes Demo of Existing Building	\$2 Million
31	Existing High School	6th - 8th	x				Addition and Renovation	\$6.2 Million - \$6.7 Million
32	New High School	9th -12th		x			New High School	\$38 Million - \$39 Million
33	New High School - Phase 2	9th - 12th		x			New High School - Phase 2	\$6.2 Million - \$6.7 Million
34	New High School - Auditorium	9th - 12th		x			New High School - Auditorium	\$10.5 Million - \$11 Million

NOT FINAL - Draft To Be Used For Planning Purposes Only



COLUMBUS SCHOOL DISTRICT
COLUMBUS, WI
07.01.19

Base & AC \$ 17,508,694

DRAFT

SUMMARY OF ALL BUILDINGS

Description	Interior & Exterior Building Upgrades			Building Systems			Exterior Improvements	Estimated Inflation & Phasing	Estimated Project Cost
	ADA Accessibility	Building Interior	Building Exterior / Envelope	Plumbing	HVAC	Electrical	Site Development		
All Buildings									
Total Cost Summary	1,022,800	7,758,000	1,274,300	1,696,000	1,137,900	3,591,400	470,800	557,494	17,508,694
Middle Schools	581,000	3,784,900	198,900	608,400	449,100	1,324,800	182,000	229,184	7,358,284
Columbus Intermediate	581,000	3,784,900	198,900	608,400	449,100	1,324,800	182,000	229,184	7,358,284
Elementary Schools	10,800	878,600	627,000	288,500	506,800	617,200	201,600	109,190	3,239,690
Columbus Elementary	10,800	878,600	627,000	288,500	506,800	617,200	201,600	109,190	3,239,690
High Schools	431,000	3,094,500	448,400	799,100	182,000	1,649,400	87,200	219,121	6,910,721
Columbus High School	431,000	3,094,500	448,400	799,100	182,000	1,649,400	87,200	219,121	6,910,721

LONG RANGE PLAN (COST INCLUDED ABOVE)

Columbus Intermediate	4,753,300
Columbus Elementary	1,122,700
Columbus High School	4,113,600

NOT FINAL - Draft To Be Used For Planning Purposes Only



REVIEW OPTIONS

TAB 8



NEW HIGH SCHOOL OPTIONS

Building	Current			Option #2A				Option #6A				Option #7B			
	ES	MS	HS	ES	MS	HS	NEW	ES	MS	HS	NEW	ES	MS	HS	NEW
Grade Config.	4K-2ND	3RD-8TH	9TH-12TH	4K-2ND	3RD-5TH	6TH-8TH	9TH-12TH	4K-4TH	DEMO	5TH-8TH	9TH-12TH	4K-5TH	DEMO	6TH-8TH	9TH-12TH
Existing	44,886	95,745	107,260	44,886	95,745	107,260		44,886	95,745	107,260		44,886	95,745	107,260	
Renovation				18,200	FACILITY MAINTENCE	44,400		18,200		44,400		18,200		44,400	
New Constuction				27,500	0	3,150	SEE SPACE PROGRAM	37,500		14,250	SEE SPACE PROGRAM	49,625		3,150	SEE SPACE PROGRAM
Auditorium						SEE PLAN	SEE SPACE PROGRAM			SEE PLAN	SEE SPACE PROGRAM			SEE PLAN	SEE SPACE PROGRAM
Demo				0	0	0		0	95,745	0		0	95,745	0	
Total Square Footage	44,886	95,745	107,260	72,386	95,745	110,410		82,386	0	121,510		94,511	0	110,410	



NEW COLUMBUS HIGH SCHOOL

OPTION #2A,6A,7B | 9TH-12TH

**NEW SITE TO BE
DETERMINED**



COLUMBUS SCHOOL DISTRICT
COLUMBUS, WISCONSIN
BRAY PROJECT NO. 3406

Bray Associates Architects, Inc.
Davenport | Milwaukee | Sheboygan

July 1, 2019

DRAFT



PRELIMINARY SPACE PROGRAM
NEW 9-12 HIGH SCHOOL | 400 STUDENTS

No.	Program Area	POTENTIAL PHASE 1				POTENTIAL FUTURE PHASE(S)				Notes
		Net Space Allocation - Proposed				Net Space Allocation - Proposed				
		Area	No	Total Net Area		Area	No	Total Net Area		
1.00	Core Curriculum									
1.01	Classrooms	900	10	9,000		900	2	1,800		
1.02	Science	1,700	3	5,100						
1.03	Prep	400	2	800						
1.04	Storage	100	2	200						
1.05	Physics	1,700	1	1,700						
1.06	Prep	400	1	400						
1.07	Storage	100	1	100						
1.08	Collaboration Spaces	1,000	3	3,000		1,000	1	1,000		
1.09	Business Classroom	1,200	1	1,200						
1.10	World Languages	900	1	900		900	1	900		
1.11	Flex Classrooms					900	2	1,800		
Total Core Curriculum Area:				22,400				5,500		
2.00	STEM / Tech. Ed.									
2.01	Autos/Metals/Welding Lab	2,500	1	2,500						
2.02	Tool Storage	300	1	300						
2.03	Material Storage	500	1	500						
2.04	Data	40	1	40						
2.05	Construction Lab	2,000	1	2,000						
2.06	Tool Control	400	1	400						
2.07	Construction Storage	600	1	600						
2.08	Finishing	300	1	300						
2.09	Engineering Lab/Classroom	1,400	1	1,400						
2.10	Storage	200	1	200						
2.11	STEM Commons/Collab	1,000	1	1,000						
2.12	AG. Lab	1,400	1	1,400						
2.13	Offices	120	-	-						
2.14	Small Animals	200	1	200						
2.15	Greenhouse	1,000	1	1,000						
Total STEM / Tech. Ed. Area:				11,840				-		
3.00	Music									
3.01	Choir	1,800	1	1,800						
3.02	Practice Rooms	100	3	300						
3.03	Ensemble Room	220	1	220						
3.04	Office	140	1	140						
3.05	Band	2,400	1	2,400						
3.06	Ensemble Room	250	1	250						
3.07	Practice Rooms	100	3	300						
3.08	Instrument Storage	400	1	400						

No.	Program Area	POTENTIAL PHASE 1				POTENTIAL FUTURE PHASE(S)				Notes
		Net Space Allocation - Proposed				Net Space Allocation - Proposed				
		Area	No	Total Net Area		Area	No	Total Net Area		
3.00	Music - continued									
3.09	Office	140	1	140						
3.10	Orchestra	2,300	-	-						
3.11	Show Choir	2,500	-	-						
3.12	Library / Repair	350	1	350						
3.13	Uniform Storage	200	1	200						
3.14	Department Storage	150	1	150						
	Total Music Area:			6,650				-		
4.00	Computers/Technology									
4.01	Computer Lab	1,200	-	-	1,200	-	-			
	Total Comp/Tech Area:			-				-		
5.00	Special Education									
5.01	Cross Categorical	900	1	900	900	1	900			Final needs TBD
5.02	Toilet/Shower/Laundry	100	1	100						
5.03	Speech	250	1	250	250	1	250			
5.04	ELL	250	1	250	250	1	250			
5.05	OT/PT/Therapy Room	900	1	900						
5.06	Storage	100	1	100						
5.07	Sensory Room	65	2	130	65	1	65			Spread throughout school
	Total Special Ed Area:			2,630				1,465		
6.00	Library									
6.01	Library	3,000	1	3,000						
6.02	Circulation Desk	200	1	200						
6.03	Work Room/Office/Storage	400	1	400						
6.04	IT Support/Helpdesk	120	1	120						
6.05	Storage/Setup	100	1	100						
6.06	Small Group Instruc/Conf	140	3	420						
	Total Library Area:			4,240				-		
7.00	Art									
7.01	Drawing/Painting	1,300	1	1,300						
7.02	Storage	200	1	200						
7.03	3D Art	1,300	1	1,300						
7.04	Storage	300	1	300						
7.05	Kiln	100	1	100						
7.06	Graphic Arts	1,400	-	-						
7.07	Storage	250	-	-						
7.08	Photography	1,500	-	-						
7.09	Storage	250	-	-						
	Total Art Area:			3,200				-		
8.00	F&CE									
8.01	Traditional Kitchen	1,400	1	1,400						
8.02	Storage	200	1	200						
8.03	Nursing	1,200	-	-						
8.04	Storage	140	-	-						
8.05	Toilet	75	-	-						
	Total F&CE Area:			1,600				-		
9.00	Physical Education									
9.01	Fieldhouse	13,500	1	13,500	7,800	1	7,800			2 courts phase 1 + 1 future
9.02	Storage	500	1	500	250	1	250			
9.03	Health Classroom	900	-	-	900	1	900			
9.04	Training	350	1	350						
9.05	Storage	120	1	120						
9.06	Concessions	250	1	250						





No.	Program Area	POTENTIAL PHASE 1				POTENTIAL FUTURE PHASE(S)				Notes
		Net Space Allocation - Proposed			Net Space Allocation - Proposed					
		Area	No	Total Net Area	Area	No	Total Net Area			
9.00	Physical Education - continued									
9.07	Family Toilets	100	1	100		100	1	100		
9.08	Women's PE & Team Locker Room	1,200	2	2,400						
9.09	Office	140	2	280						
9.10	Locker/Toilet	180	2	360						
9.11	Shower	200	2	400						
9.12	Toilet	150	2	300						
9.13	Men's PE & Team Locker Room	1,200	2	2,400						
9.14	Office	140	2	280						
9.15	Locker/Toilet	180	2	360						
9.16	Shower	200	2	400						
9.17	Toilet	150	2	300						
9.18	Locker/Toilet	170	1	170						
9.19	Shower	225	1	225						
9.20	Toilet	170	1	170						
9.21	Coach's Office	250	1	250						
9.22	Lockers/Toilet/Shower	100	2	200						
9.23	P.E. Storage	500	1	500						
9.24	Equipment Drying	300	1	300						
9.25	Weights/Fitness/Cross Fit	3,500	1	3,500						
9.26	Storage	150	1	150						
9.27	Wrestling	3,600	1	3,600					Two 42'x42' mats	
9.28	Storage	150	1	150						
9.29	Team Storage	600	1	600						
9.30	Pool		not included			not included				
9.31	Gymnastics		not included			not included				
	Total Physical Educ Area:			32,115			9,050			
10.00	Admin & Student Services									
10.01	Principal Office	200	1	200						
10.02	Reception / Lobby / Waiting Area	250	1	250					2 Secretary Desks	
10.03	Associate Principal Office	180	-	-						
10.04	Police Liaison	180	1	180						
10.05	Nurse Office	150	-	-						
10.06	Health	400	1	400						
10.07	Student Waiting Area	150	-	-						
10.08	Toilet	65	1	65						
10.09	Records Storage	50	-	-						
10.10	Conference Room	300	1	300					10-12 Seated	
10.11	Work room	200	1	200						
10.12	Toilet	65	1	65						
10.13	Kitchenette	50	1	50						
10.14	Coat Closet	25	1	25						
10.15	In School Suspension	50	1	50						
10.16	Guidance/Reception	200	1	200					1 Secretary Desk	
10.17	Guidance Counselor Office	150	2	300						
10.18	Psychologist Office	150	1	150						
10.19	Social Worker Office	150	-	-						
10.20	Future / Flex Office	150	1	150						
10.21	Conference Room	300	1	300					10-12 Seated	
10.22	Records Storage	80	1	80						
10.23	Athletic Director Office	150	1	150						
10.24	Storage	80	1	80						
	Total Admin & SS Area:			3,195			-			

No.	Program Area	POTENTIAL PHASE 1				POTENTIAL FUTURE PHASE(S)				Notes
		Net Space Allocation - Proposed				Net Space Allocation - Proposed				
		Area	No	Total Net Area		Area	No	Total Net Area		
11.00	Staff Work & Break									
11.01	Staff Break/Lunch	700	1	700						
11.02	Toilet	65	2	130						
	Total Staff Area:			830				-		
12.00	Cafeteria/Kitchen									
12.01	Main Cafeteria	2,600	1	2,600						200 @ 13 sq ft per student
12.02	Kitchen	1,200	1	1,200						
12.03	Servery	800	1	800						
12.04	Dishwasher	120	1	120						
12.05	Freezer/Coolers	400	2	800						
12.06	Dry Storage	200	1	200						
12.07	Office	180	1	180						
12.08	Lockers	75	1	75						
12.09	Toilet	60	1	60						
12.10	Table Storage	250	1	250						
12.11	Custodial Storage/Scrubber	120	1	120						
	Total Cafe/Kitchen Area:			6,405				-		
13.00	Maintenance/Janitorial									
13.01	Janitor's Closets	50	4	200						
13.02	Office	140	1	140						
13.03	Electrical	20	5	100						
13.04	Switchgear	180	1	180						
13.05	Generator/Transformer	200	1	200						
13.06	General Building Storage	350	1	350						
13.07	Laundry	140	1	140						
	Total Maint/Janitor Area:			1,310						
14.00	Shared/Common Space									
14.01	Lobby	250	1	250						
14.02	School Store	450	1	450						
14.03	Storage	150	1	150						
14.04	Public Restroom Men's	200	5	1,000						
14.05	Public Restroom Women's	240	5	1,200						
14.06	Public Unisex Restroom	65	3	195						
14.07	Elevator	75	1	75						
14.08	Elevator Equipment Rooms	60	1	60						
	Total Shared/Common Area:			3,380				-		
	Total Building Area - Net:			99,795				16,015		
16.00	Grossing Calculation									
16.01	Circulation grossing factor	99,795	@	15.0%	15,000	16,015	@	15.0%	2,400	
16.02	Mechanical grossing factor	114,795	@	10.0%	11,500	18,415	@	10.0%	1,800	
16.03	Misc. grossing factor	114,795	@	10.0%	<u>11,500</u>	18,415	@	10.0%	<u>1,800</u>	
	Total Grossing Factors:				38,000			6,000		
	Total Building Area:		Phase 1:	137,795	Potential Future:	22,015				



COLUMBUS SCHOOL DISTRICT
COLUMBUS, WISCONSIN
BRAY PROJECT NO. 3406

DRAFT



Bray Associates Architects, Inc.
Davenport | Milwaukee | Sheboygan

June 25, 2019

PRELIMINARY SPACE PROGRAM
NEW PERFORMING ARTS CENTER (600 Seats)

No.	Program Area	Net Space Allocation - Proposed			Notes
		Area	No	Total Net Area	
1.00	House				
1.01	House / Seating	7,100	1	7,100	Seating for 600
1.02	Control Booth	120	1	120	
1.03	Sound Patio	80	1	80	
1.04	Follow Spot Booth	40	2	80	
1.05	Light Locks	80	4	320	
	Total House Area:			7,700	
2.00	Stage / Performance				
2.01	Stage	3,500	1	3,500	Includes Wing Space (2 @ 20' x 30')
2.02	Orchestra Pit with Access	1,500	1	1,500	
	Total Stage / Performance Area:			5,000	
3.00	Back of House				
3.01	Dressing/Make-Up/Toilets	1,000	2	2,000	
3.02	Green Room	200	1	200	
3.03	Wardrobe and Property Storage	1,000	1	1,000	
3.04	Stagecraft / Scene Shop	2,200	1	2,200	
3.05	Spray Booth	100	1	100	
3.06	Stagecraft / Scene Storage	1,000	1	1,000	
3.07	Piano Garage	120	1	120	
3.08	Receiving	500	1	500	
3.09	General Storage	500	1	500	
	Total Back of House Area:			7,620	
4.00	Front of House				
4.01	Box Office / Ticket Booth	400	1	400	
4.02	Concessions	400	1	400	
4.03	Coats	400	1	400	
4.04	Manager's Office	200	1	200	
4.05	Public Restroom Men	450	1	450	
4.06	Public Restroom Women	650	1	650	
4.07	Lobby	5	-	-	utilize Cafeteria as Lobby
	Total Front of House Area:			2,500	
	Total Building Area - Net:			22,820	
5.00	Grossing Factors				
5.01	Circulation grossing factor	22,820	@	15.0%	3,400
5.02	Mechanical grossing factor	26,220	@	10.0%	2,600
5.03	Misc. grossing factor	26,220	@	10.0%	2,600
	Total Grossing Factors:			8,600	
	Total Building Area:			31,420	



COLUMBUS ELEMENTARY SCHOOL

OPTION #2A | 4K-2ND

Assumptions:

- Courtyard
- New playground location
- New asphalt play area
- New Main Entry



Color Key:

- = Existing
- = New Construction

SITE PLAN
not to scale



COLUMBUS ELEMENTARY SCHOOL

OPTION #2A | 4K-2ND



Assumptions:

- 1 - 4K Classroom
- 14 - K-2nd Grade Classrooms
- 2 - Flex Classrooms
- Seperate Gym & Cafeteria
- Seperate Art & Music
- Unlabeled rooms will support special ed, staff work, and other important programmatic needs



FIRST FLOOR PLAN
not to scale

Color Key:

-  = Existing
-  = Renovation
-  = New Construction





COLUMBUS INTERMEDIATE SCHOOL

OPTION #2A | 3RD-5TH

Assumptions:

- See infrastructure improvements



Color Key:

= Existing

= New Construction

SITE PLAN
not to scale



COLUMBUS MIDDLE SCHOOL - CURRENT HIGH SCHOOL

OPTION #2A | 6TH-8TH

Assumptions:

- Loading dock for the Kitchen



Color Key:

■ = Existing

■ = New Construction

SITE PLAN
not to scale



COLUMBUS MIDDLE SCHOOL - CURRENT HIGH SCHOOL

OPTION #2A | 6TH-8TH

Assumptions:

- 12 - 9th-12th Grade Classroom
- 2 - Flex Classrooms
- 2 - Music Classrooms
- 4 - STEAM Classrooms
- 3 - Science Classrooms
- Seperate Gym & Cafeteria
- Seperate Art & Music
- Unlabeled rooms will support special ed, staff work, and other important programmatic needs



Color Key:

-  = Existing
-  = Renovation
-  = New Construction

FIRST FLOOR PLAN
not to scale



COLUMBUS ELEMENTARY SCHOOL

OPTION #6A | 4K-4TH

Assumptions:

- Courtyard
- New playground location
- New asphalt play area
- New Main Entry
- Potential Gymnasium Expansion



Color Key:

-  = Existing
-  = New Construction

SITE PLAN
not to scale



COLUMBUS ELEMENTARY SCHOOL

OPTION #6A | 4K-4TH

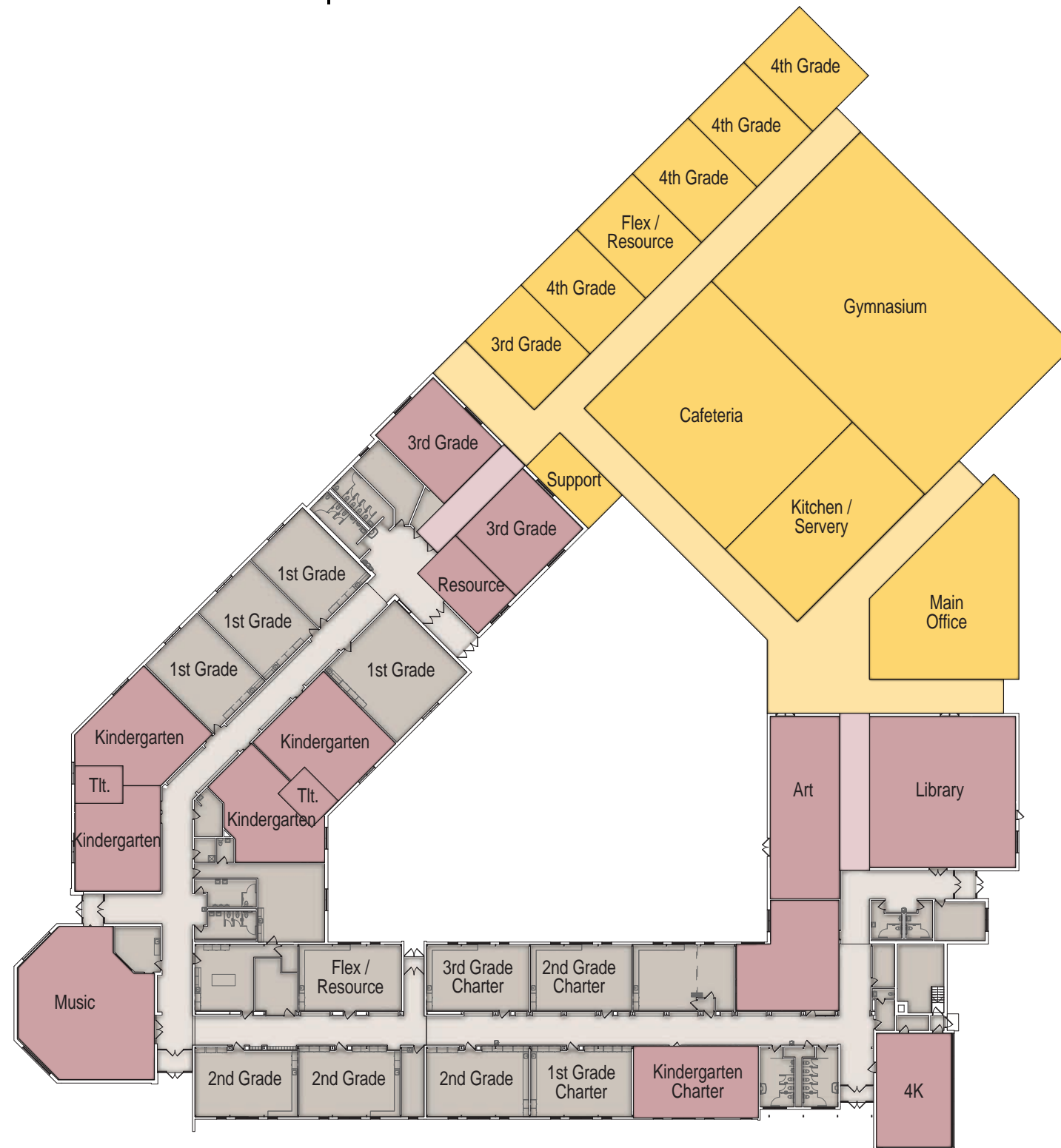

Assumptions:

- 1 - 4K Classroom
- 22 - K-4th Grade Classrooms
- 2 - Flex Classrooms
- Seperate Gym & Cafeteria
- Seperate Art & Music
- Unlabeled rooms will support special ed, staff work, and other important programmatic needs
- Potential Gymnasium Expansion



FIRST FLOOR PLAN
not to scale

Color Key:

-  = Existing
-  = Renovation
-  = New Construction



COLUMBUS MIDDLE SCHOOL - CURRENT HIGH SCHOOL

OPTION #6A | 5TH-8TH

Assumptions:

- Loading dock for the Kitchen
- Relocate greenhouse
- See infrastructure improvements



Color Key:

-  = Existing
-  = New Construction

SITE PLAN
not to scale



COLUMBUS MIDDLE SCHOOL - CURRENT HIGH SCHOOL

OPTION #6A | 5TH-8TH

Assumptions:

- 16 - 5th-8th Grade Classroom
- 3 - Flex Classrooms
- 2 - Music Classrooms
- 3 - STEAM Classrooms
- 4 - Science Classrooms
- Seperate Gym & Cafeteria
- Unlabeled rooms will support special ed, staff work, and other important programmatic needs

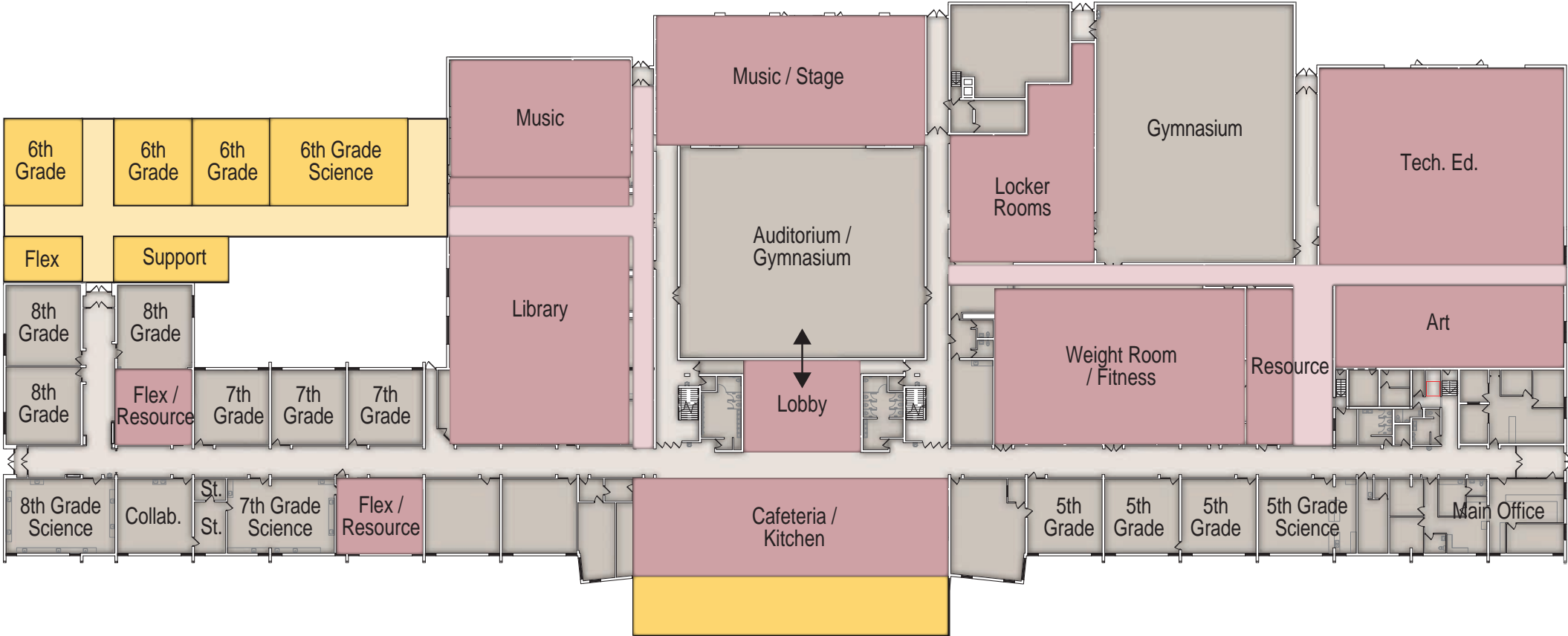

- Color Key:
- = Existing
 - = Renovation
 - = New Construction

FIRST FLOOR PLAN
not to scale



COLUMBUS ELEMENTARY SCHOOL

OPTION #7B | 4K-5TH

Assumptions:

- Courtyard
- New playground location
- New asphalt play area
- New Main Entry
- Potential Gymnasium Expansion



Color Key:

- = Existing
- = New Construction

SITE PLAN
not to scale



COLUMBUS ELEMENTARY SCHOOL

OPTION #7B | 4K-5TH

Assumptions:

- 1 - 4K Classroom
- 26 - K-4th Grade Classrooms
- 3 - Flex Classrooms
- Seperate Gym & Cafeteria
- Seperate Art & Music
- Unlabeled rooms will support special ed, staff work, and other important programmatic needs
- Potential Gymnasium Expansion
- Elevator Assumed - not shown



FIRST FLOOR PLAN
not to scale

Color Key:

- = Existing
- = Renovation
- = New Construction



COLUMBUS MIDDLE SCHOOL - CURRENT HIGH SCHOOL

OPTION #7B | 6TH-8TH

Assumptions:

- 16 - 5th-8th Grade Classroom
- 3 - Flex Classrooms
- 2 - Music Classrooms
- 3 - STEAM Classrooms
- 4 - Science Classrooms
- Seperate Gym & Cafeteria
- Unlabeled rooms will support special ed, staff work, and other important programmatic needs



Color Key:

- = Existing
- = Renovation
- = New Construction

FIRST FLOOR PLAN
not to scale



CURRENT BUILDING OPTION

Building	Current			Option #4		
	ES	MS	HS	ES	MS	HS
Grade Config.	4K-2ND	3RD-8TH	9TH-12TH	4K-3RD	4TH-8TH	9TH-12TH
Existing	44,886	95,745	107,260	44,886	95,745	107,260
Renovation				18,200	28,000	19,000
New Constuction				30,250	18,750	36,250
Auditorium						31,420
Demo				0	13,180	16,500
Total Square Footage	44,886	95,745	107,260	75,136	101,315	127,010



COLUMBUS ELEMENTARY SCHOOL

OPTION #4 | 4K-3RD

Assumptions:

- Courtyard
- New playground location
- New asphalt play area
- New Main Entry



Color Key:

- = Existing
- = New Construction

SITE PLAN
not to scale



COLUMBUS ELEMENTARY SCHOOL



OPTION #4 | 4K-3RD

Assumptions:

- 1 - 4K Classroom
- 18 - K-3rd Grade Classrooms
- 2 - Flex Classrooms
- Seperate Gym & Cafeteria
- Seperate Art & Music
- Unlabeled rooms will support special ed, staff work, and other important programmatic needs



Color Key:

-  = Existing
-  = Renovation
-  = New Construction

FIRST FLOOR PLAN
not to scale



COLUMBUS INTERMEDIATE / MIDDLE SCHOOL

OPTION #4 | 4TH-8TH

Assumptions:

- New main entry
- Expanded hard play area
- See infrastructure improvements



Color Key:

- = Existing
- = New Construction

SITE PLAN
not to scale



COLUMBUS INTERMEDIATE / MIDDLE SCHOOL

OPTION #4 | 4TH-8TH

Assumptions:

- 20 - 4rd-8th Grade Classroom
- 4 - Flex Classrooms
- 2 - Science Classrooms
- Seperate Gym & Cafeteria
- Seperate Art & Music
- Unlabeled rooms will support special ed, staff work, and other important programmatic needs
- District Office



Color Key:

- = Existing
- = Renovation
- = New Construction

FIRST FLOOR PLAN
not to scale



COLUMBUS INTERMEDIATE / MIDDLE SCHOOL



OPTION #4 | 4TH-8TH

Assumptions:

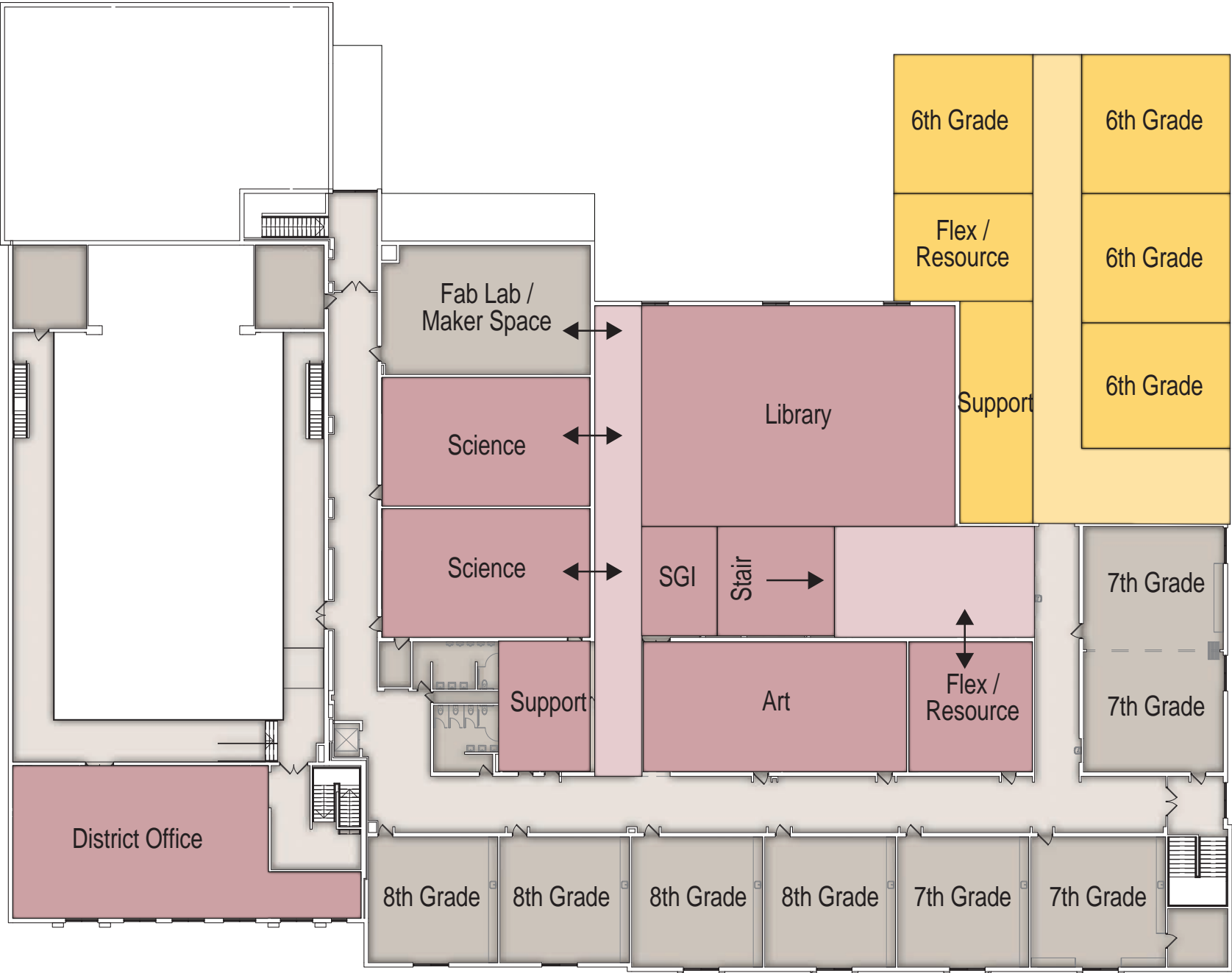
- 20 - 4rd-8th Grade Classroom
- 4 - Flex Classrooms
- 2 - Science Classrooms
- Seperate Gym & Cafeteria
- Seperate Art & Music
- Unlabeled rooms will support special ed, staff work, and other important programmatic needs
- District Office



Color Key:

-  = Existing
-  = Renovation
-  = New Construction

SECOND FLOOR PLAN
not to scale



COLUMBUS HIGH SCHOOL

OPTION #7B | 9TH-12TH

Assumptions:

- Loading dock for the Kitchen
- Auditorium drop-off
- New parking
- Relocated Greenhouse

Color Key:

= Existing

= New Construction



SITE PLAN
not to scale



COLUMBUS HIGH SCHOOL



OPTION #4 | 9TH-12TH

Assumptions:

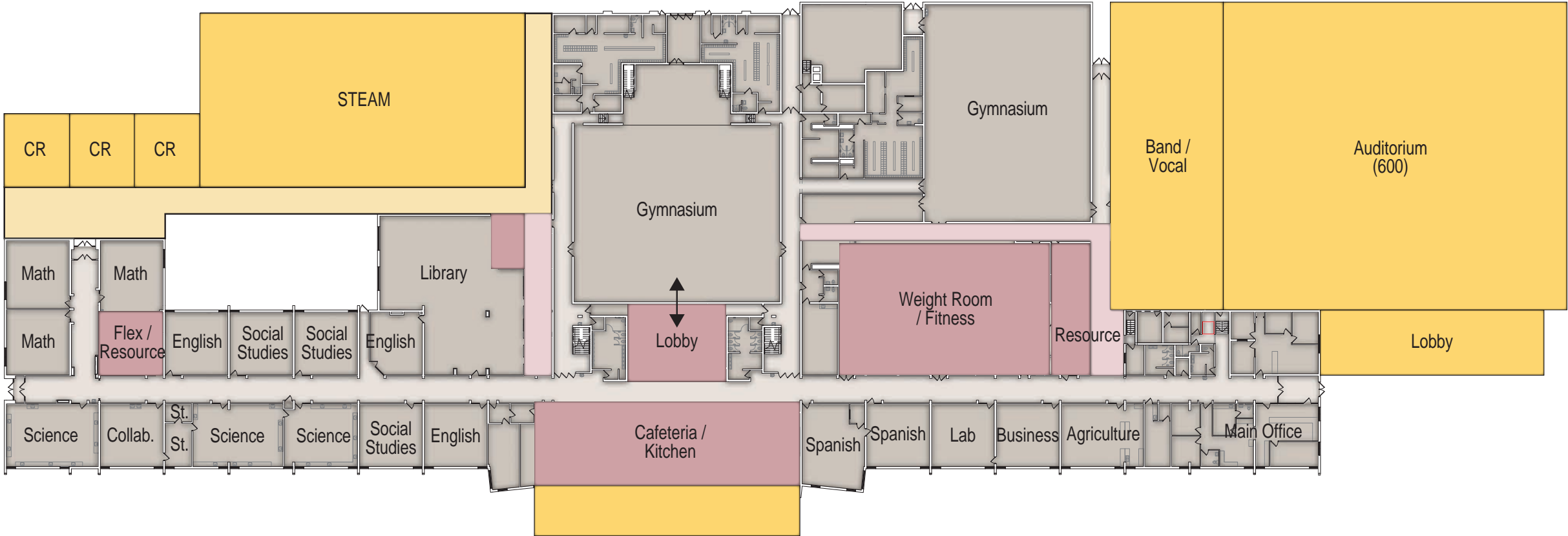
- 16 - 9th-12th Grade Classroom
- 2 - Flex Classrooms
- 2 - Music Classrooms
- 6 - STEAM Classrooms
- 4 - Science Classrooms
- Seperate Gym & Auditorium
- Unlabeled rooms will support special ed, staff work, and other important programmatic needs



Color Key:

-  = Existing
-  = Renovation
-  = New Construction

FIRST FLOOR PLAN
not to scale



POTENTIAL PHASING

TAB 11

COLUMBUS SCHOOL DISTRICT

TAX IMPACT ON SAMPLE PROPERTY VALUES

BORROWING AMOUNT	\$20,000,000
LENGTH OF BORROWING(S)	20 Years
EXAMPLE INTEREST RATE(S)	3.75% / 4.00%

ESTIMATED TAXPAYER IMPACT	Per \$1,000 of Property Fair Market Value ("FMV")
---------------------------	---

MAXIMUM MILL RATE IMPACT	\$0.96
---------------------------------	---------------

IMPACT ON SAMPLE PROPERTY VALUES

\$100,000 FMV (based on maximum mill rate)	
Annual	\$96.00
Monthly	\$8.00
\$150,000 FMV (based on maximum mill rate)	
Annual	\$144.00
Monthly	\$12.00
\$200,000 FMV (based on maximum mill rate)	
Annual	\$192.00
Monthly	\$16.00
\$300,000 FMV (based on maximum mill rate)	
Annual	\$288.00
Monthly	\$24.00



Key Assumptions:

State aid impact based on prior fiscal year incremental expenditure over base year at the following aid level (2018-19 October certification):

Tertiary Aid Percentage..... 4.52%

Mill rate based on 2018 Equalized Valuation (TID-OUT) of \$752,068,925 with annual growth of 2.00%.

NOTE: Mill rate may remain unchanged or decline in upcoming years if referendum not approved.



Do you have children attending school in the District?

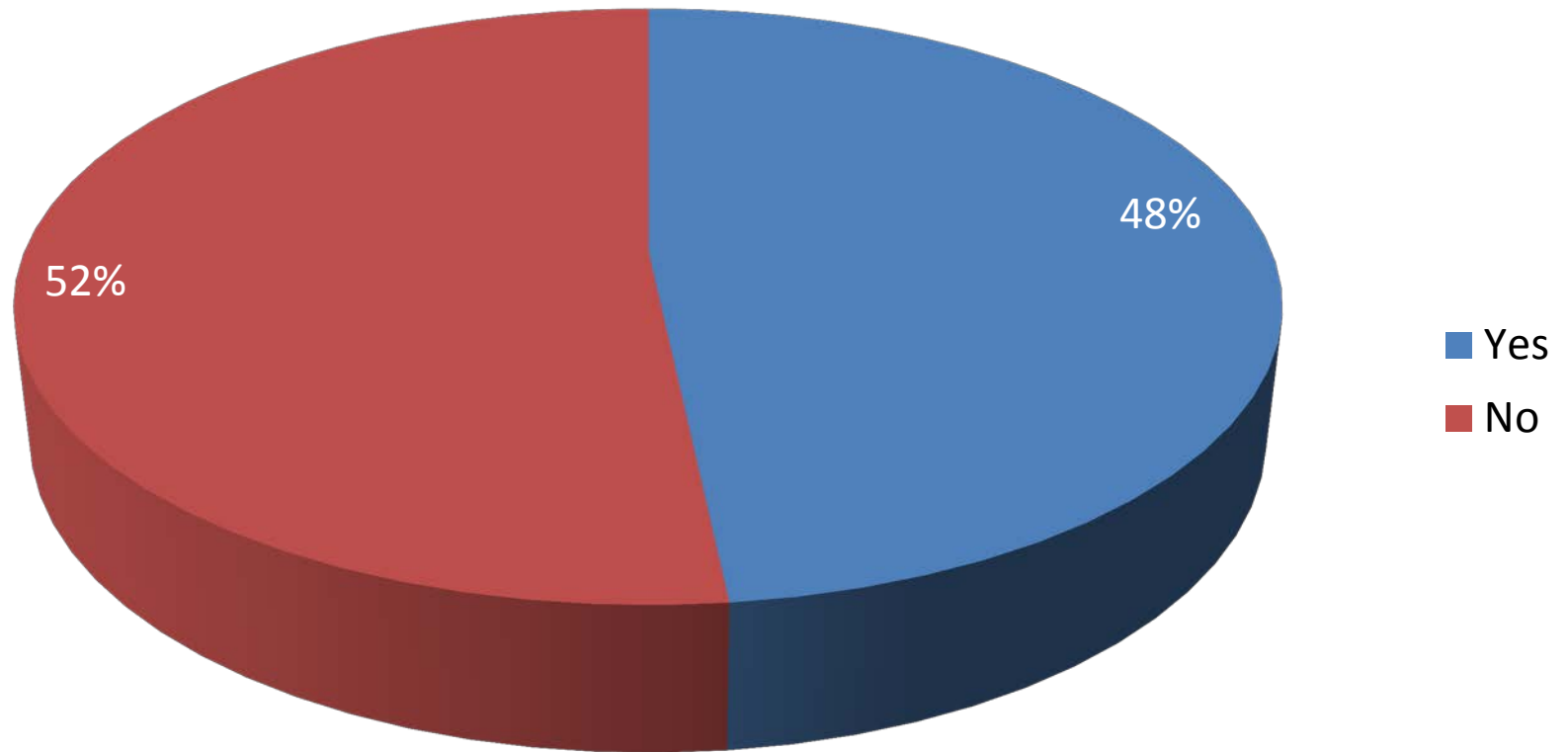

Would you likely support a referendum to help the District update facilities and improve operational efficiencies?

(All residents)

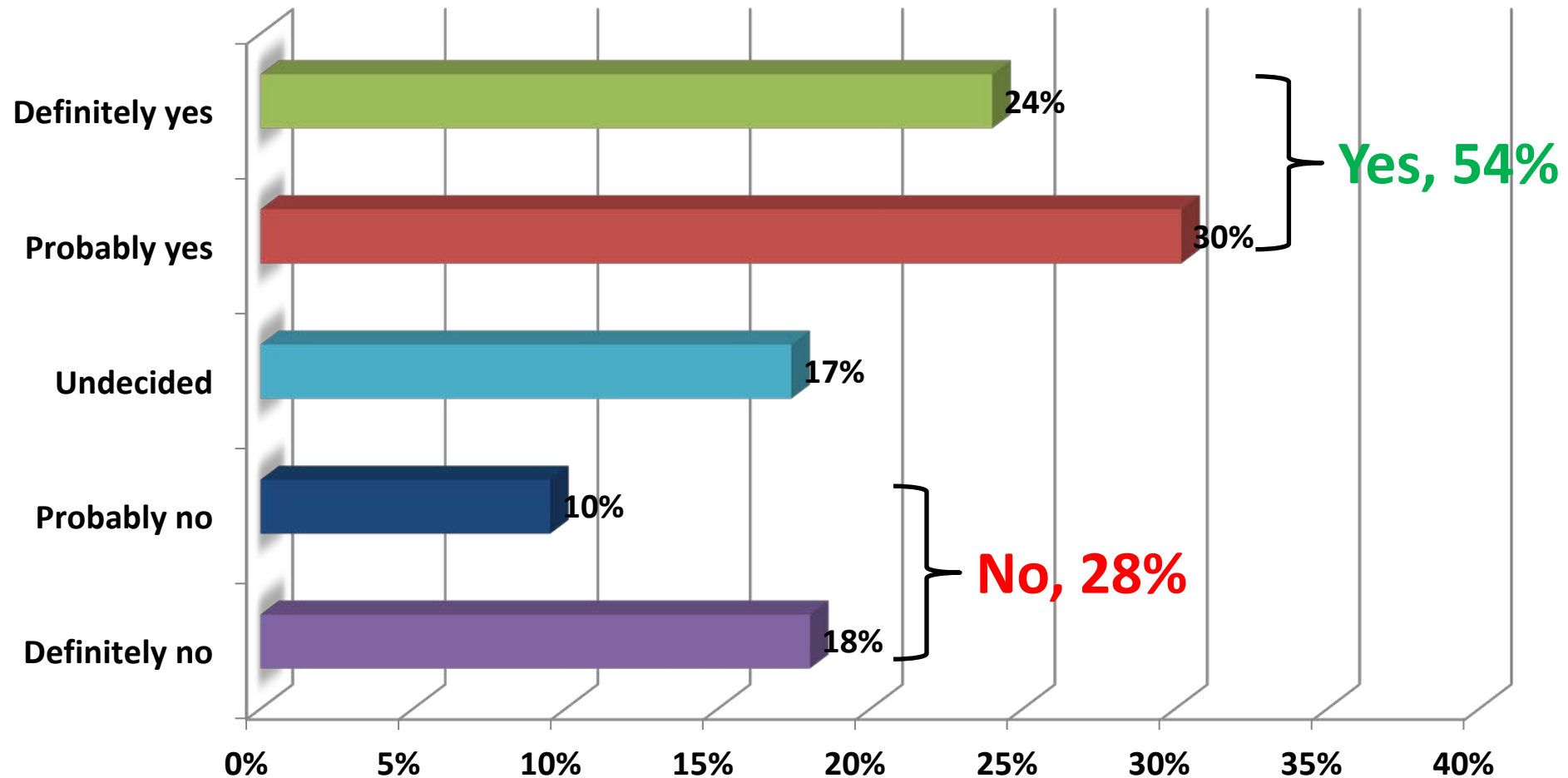

Would you likely support a referendum to help the District update facilities and improve operational efficiencies?

(All resident staff)

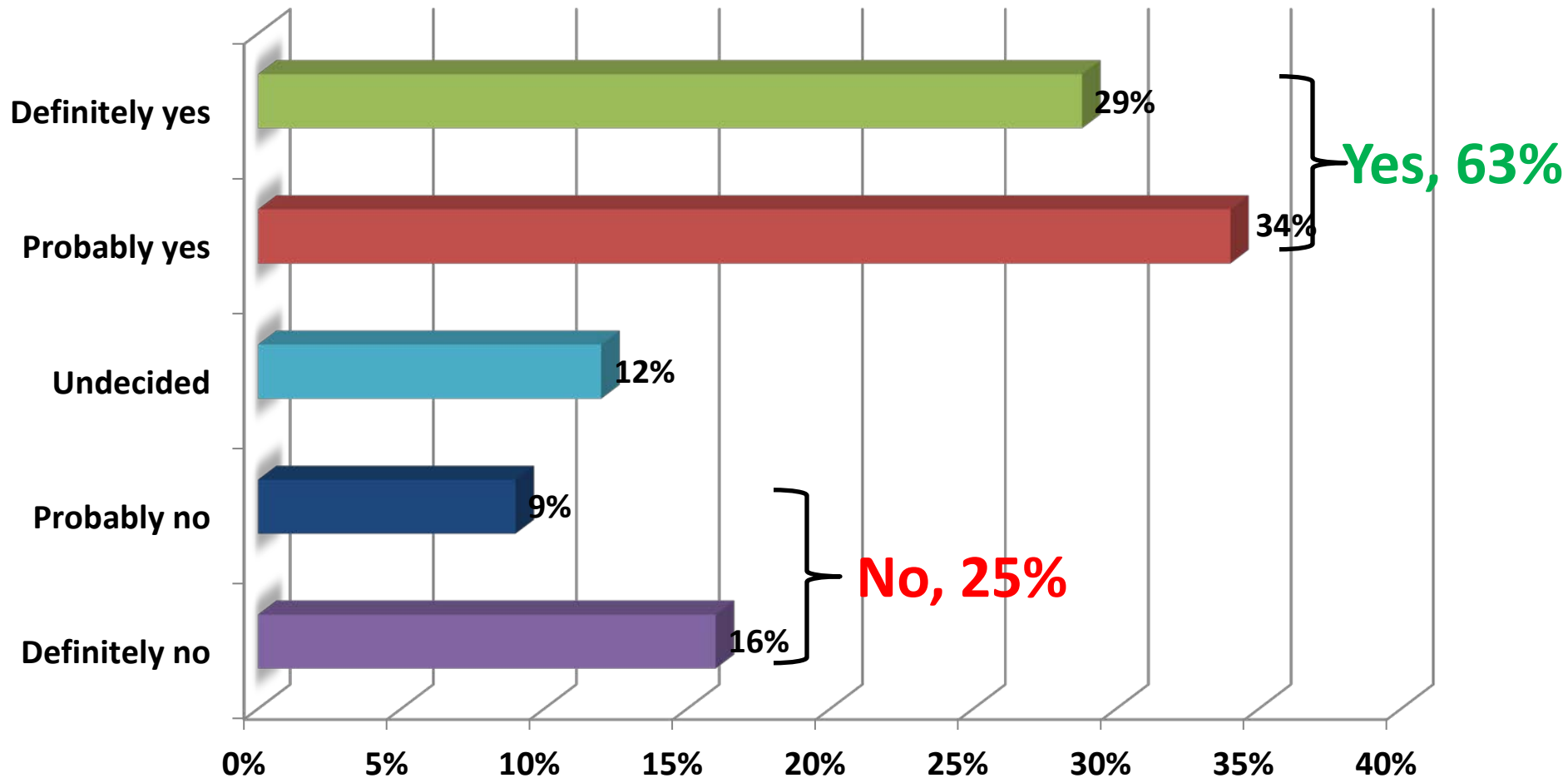

Would you likely support a referendum to help the District update facilities and improve operational efficiencies?

(All resident parents)

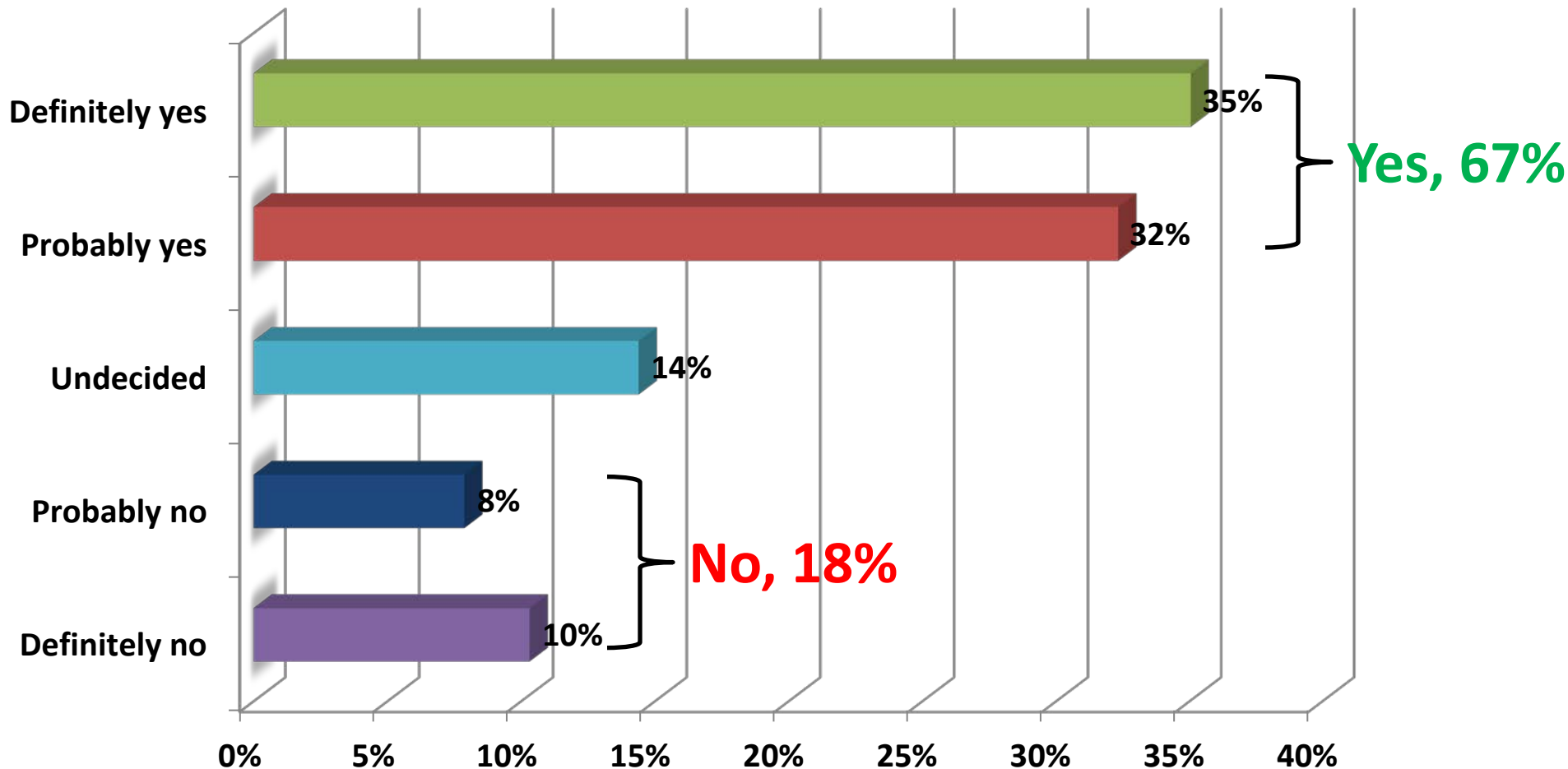

Would you likely support a referendum to help the District update facilities and improve operational efficiencies?

(All resident non-parents)

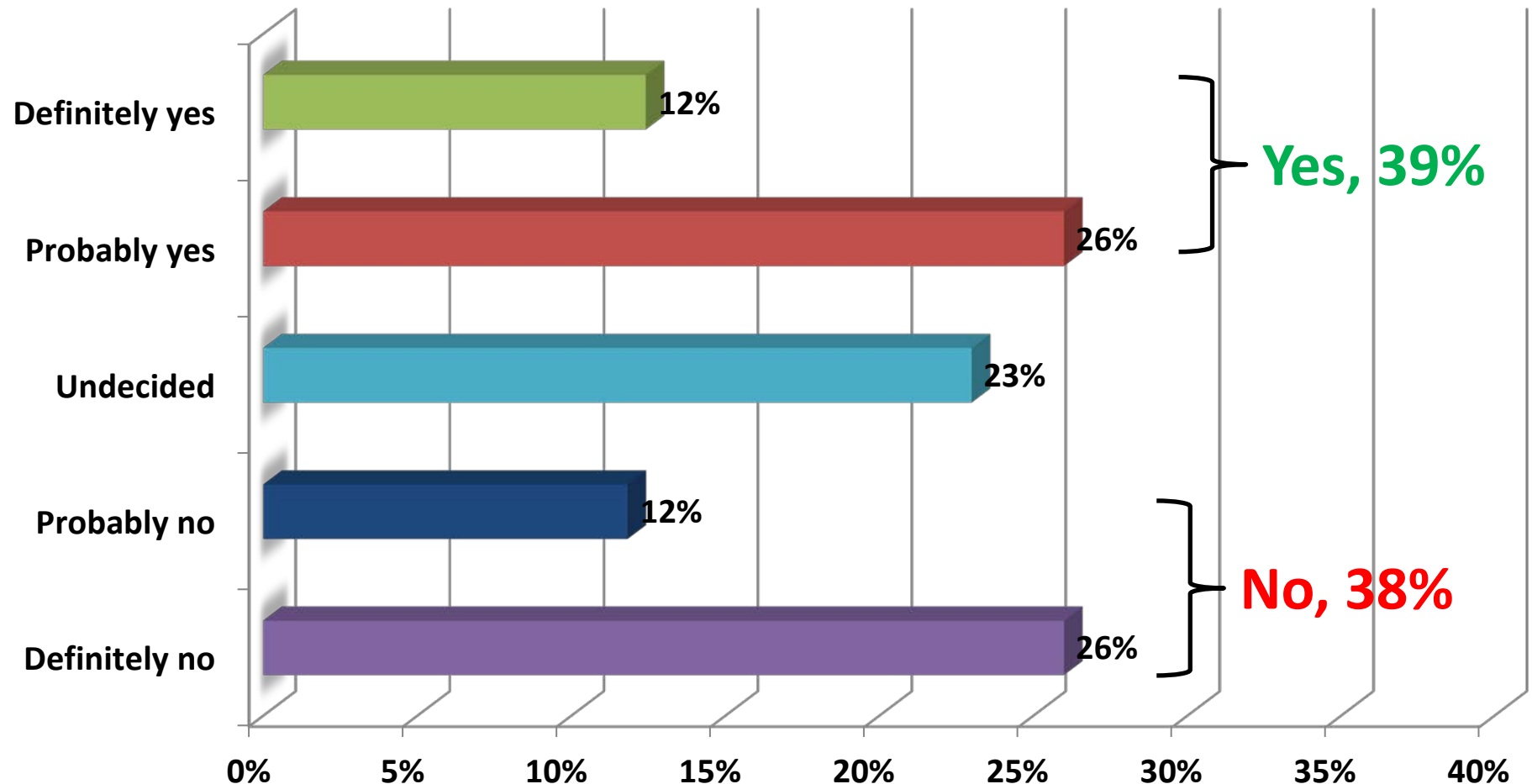

**If you would likely support a referendum,
how much of a tax increase would you be
willing to support, assuming the projects
included were acceptable to you?**

(All residents)

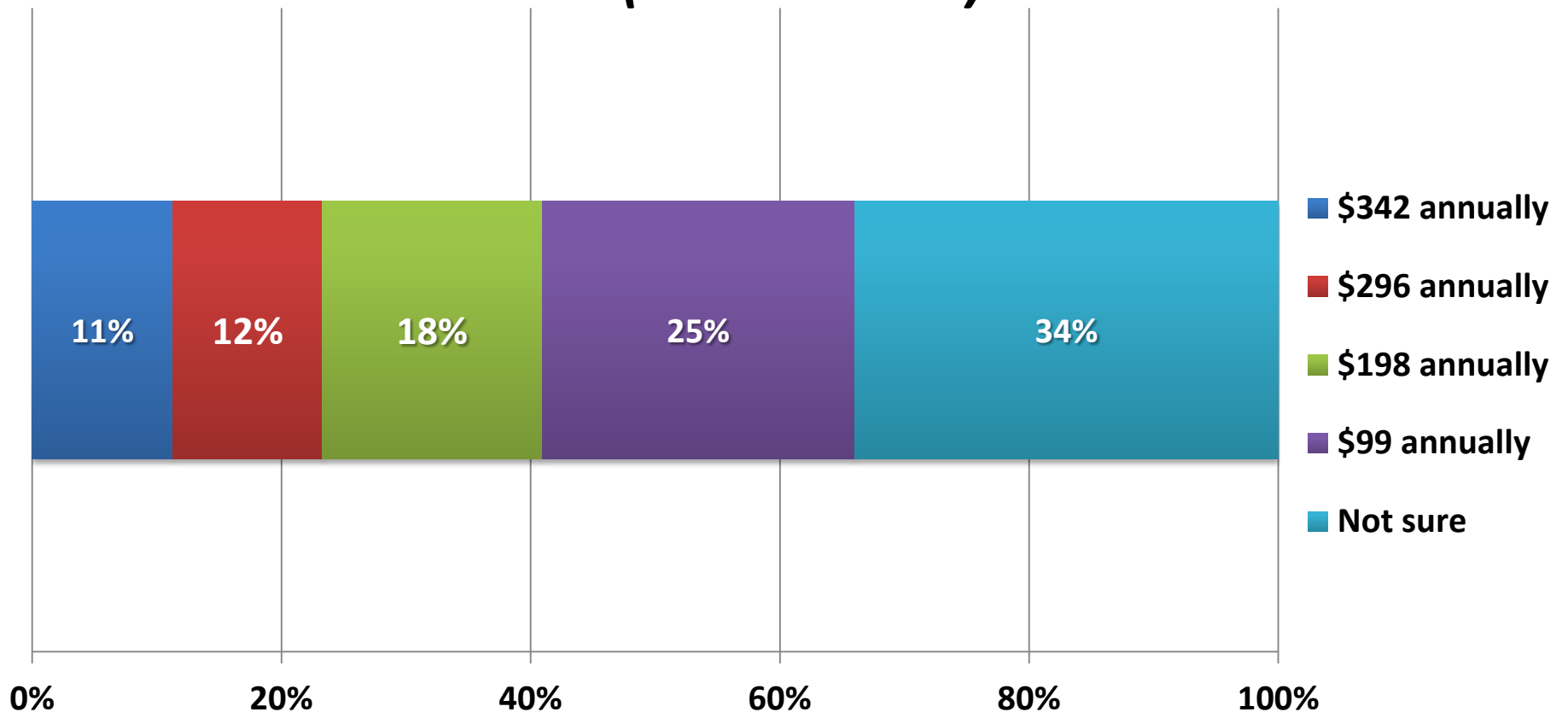



Monday | July 1, 2019

POTENTIAL PHASING - WORKSHEET

Option	#2A / #6A / #7B	#4
Phase #1 if \$20 million		
Additional Scope if Phase #1 \$25 million		
Additional Scope if Phase #1 \$30 million		



THANK YOU

NEXT MEETING

MONDAY JULY 15- 6:00-8:30

HIGH SCHOOL LIBRARY